



Features:

- Wide Beam Angle
- Built in aluminum heat sink , with 94 V0 Fire-Rated PC housing
- IP65: Integral design and fully compact structure
- No Glass
- End knock out permits conduit connection on TC Model, can be cord connected through top by end cap if specified on order
- Fixture comes with mounting/hanging kit included for wall, ceiling or suspended mount
- Full range of options: Emergency backup, Occupancy sensor, 0-10V Dimming
- TC = 1/2" Knock Out Cord Set Available
- Sensor hold time 5 minutes, then dims to 20%. **Does NOT turn off**

- **Input Voltage** : 120 - 277 VAC
- **Power** : 25W - 70W
- **Frequency** : 50 / 60 Hz
- **Lumen Efficacy** : 120 lumens per watt
- **Operating Temperature** : -25°F - + 40°C
- **Power Factor** : >0.9
- **Beam Angle** : 270°
- **THD**: <18%
- **Lifespan** : 50,000 hours
- **DLC Standard**
- **Warranty** : 5 years
- **Color Temperature** : 4000K - 5000K in stock

Options :

- **OC** : Occupancy Sensor
- **EM** : Emergency Back-up, meets UL924 (EM remote, #61324, required for testing, one per location. Emergency operating temperature -13°F - +104°F)
- **Output in EM Mode:**
 TPAL-5L: 6 Watt, 744 Lumens
 TPAL-8L: 6 Watt, 760 Lumens

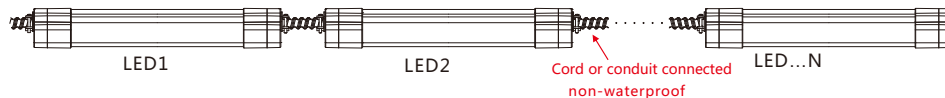

TPAL-TC

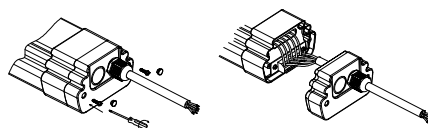

Specification/Product Parameters

- **Input voltage:** 90~305VAC
- **Power:** 20W~70W
- **Frequency:** 50/60Hz
- **Lumen Efficacy:** 120LM/W
- **Operating temperature:** -25°~+40° (Emergency minimum temperature -10°C)
- **Power factor:** > 0.9
- **Beam angle:** 270°
- **THD:** < 18%
- **Lifespan:** 50000H

Note: TPAL 96 strips (8' strips) may be subjected to additional freight charges due to oversize ratings for shipment. This MAY affect the free freight allowance on SOME orders.

Model#	Ref#	Lumens	LmW	Color Temp (°K)	Watt	Input Voltage
TPAL24-2L-40K-UL-OC-ST-TC	61628	2330	119	4000	20	120-277 V
TPAL24-2L-50K-UL-OC-ST-TC	61631	2407	124	5000	20	120-277 V
TPAL48-5L-40K-UL-OC-EM-ST-TC	61629	4989	117	4000	43	120-277 V
TPAL48-5L-50K-UL-OC-EM-ST-TC	60632	5476	122	5000	45	120-277 V
TPAL96-8L-40K-UL-OC-EM-ST-TC	61630	7895	115	4000	69	120-277 V
TPAL96-8L-50K-UL-OC-EM-ST-TC	61633	8944	119	5000	69	120-277 V

RMSTEM Remote	61324		0			
---------------	-------	--	---	--	--	--

Installation Instructions

Ceiling or Wall Mount

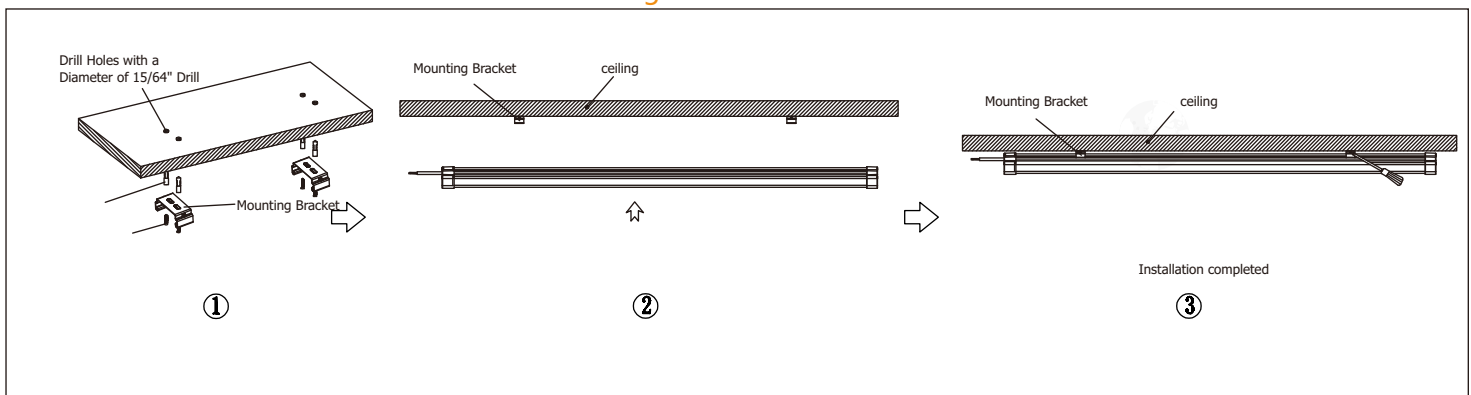



(PG9 connector)

Included



(Mounting Kit)

Included



Diagram of remote control(Emergency)

#61324 Optional

Dimension



Type TC

Model TC Dim	L(inches)	L2 (Inches)	W (Inches)	H (Inches)
	TPAL24	25.6	21.3	3.7
TPAL48	49.2	44.9	3.7	2.4
TPAL96	96.5	92.1	3.7	2.4

—Emergency (Remote Controller Required) Remote - Part #61324

- High Temp. Ni-MH battery. Compact in size, longer lifetime, safer in practical use, RoHS compliant;
- The nickel-metal hydride batteries can be repeated 500 charge-discharge cycles by correct operation;
- After leaving factory, the emergency battery turns itself into a dormant state to avoid electric discharge and leakage;

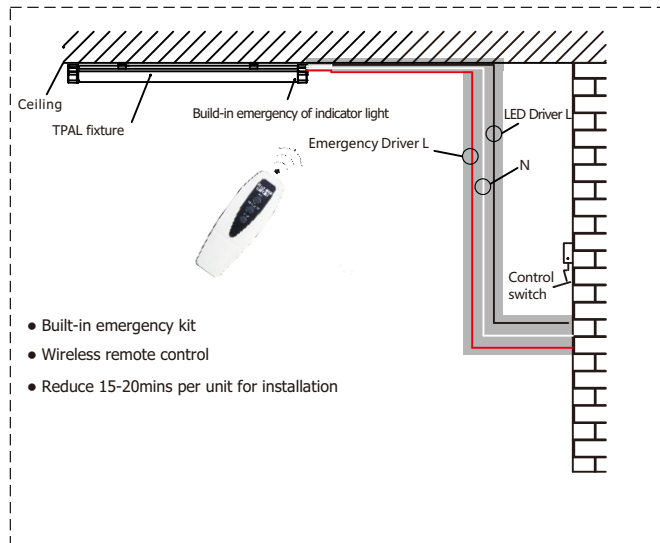

—Controller

- The utilization of wireless IR remote controller:

Button#1: TEST (Press this button, switch to emergency lighting model. Emergency indicator light turns red)

Button#2: DISCHARGE (Press this button, battery starts to discharge, emergency indicator shows up red until electrical discharge process is over. 5 sec later, this lamp switches to normal working state);

Button#3: STOP

1. Stop discharge (pause discharge when in emergency status)
2. Cancel automatic discharge (keep pressing button 3 seconds, when red indicator flicker once, means closed every 3 month automatic discharge function.)
3. Start automatic discharge (keep pressing button 3 seconds, when red indicator continues flicker, means start every 3 month automatic discharge function.)

